

LT-APO/532-RAMAN/0.82

Art.Nr.: 1015091

Technical Specifications

Optical Data	
clear aperture	4.7 mm
focal length	2.88 mm
numerical aperture(NA)	0.82
working distance	0.64 mm (1.40 mm)
Spectral Performance	
AR coating (> 80% transmission)	400 .. 1000 nm
apochromatic range (df < +/- delta)	520 .. 695 nm ⁽¹⁾
Compatibility	
environment	low temperature, high magnetic fields, high vacuum
compatible setups	CFM I, AFM/CFM, attoDRY800
suitable broadband collimator	RT-APO/VIS-NIR/0.13
Size and Dimensions	
diameter	24 mm
length	48.35 mm
weight	43 g

⁽¹⁾ df: chromatic focal shift, $\Delta = n \cdot \lambda_{\text{ref}} / (2 \cdot NA^2)$: depth of focus, n: refractive index, λ_{ref} : wavelength used to define focal plane with max. Δ



Simulation Data on Chromatic Performance

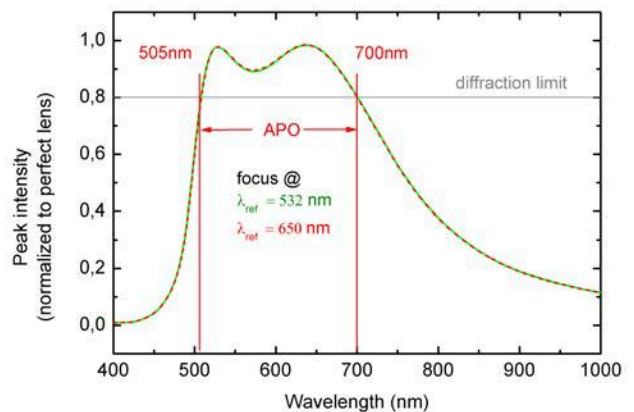
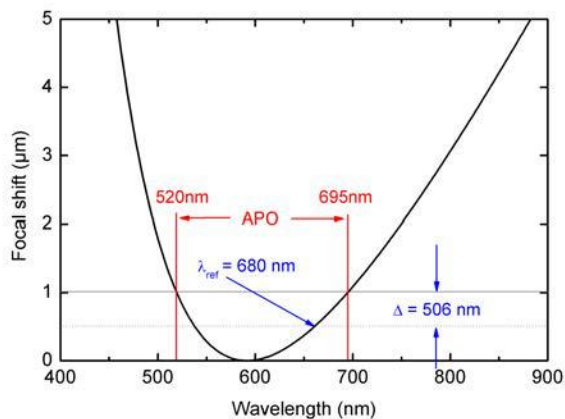

Technical Drawings

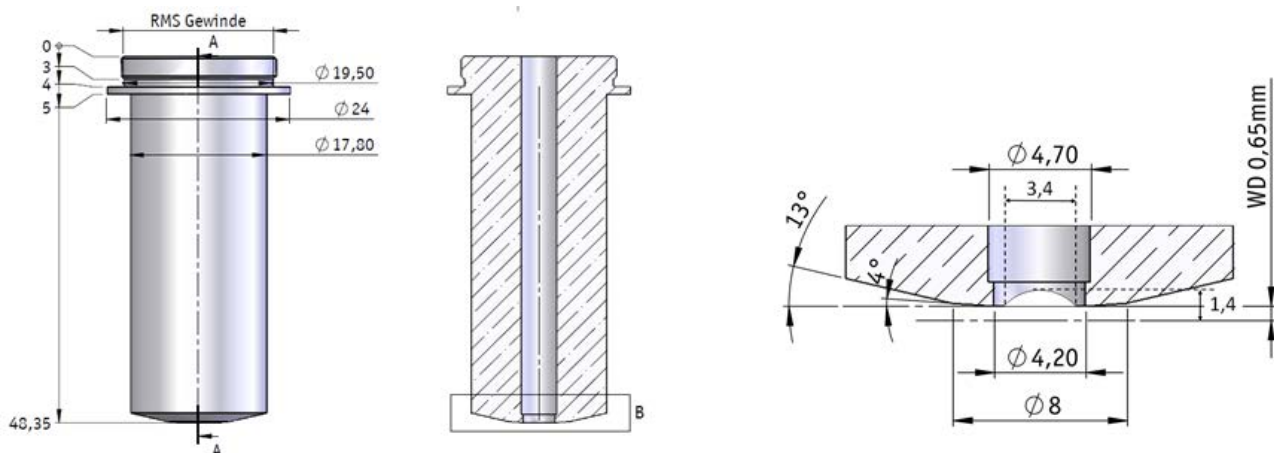

LT-APO/532-RAMAN/0.82/xs

Art.Nr.: 1015092

Technical Specifications

Optical Data	
clear aperture	4.7 mm
focal length	2.88 mm
numerical aperture(NA)	0.82
working distance	0.64 mm (1.40 mm)
Spectral Performance	
AR coating (> 80% transmission)	400 .. 1000 nm
apochromatic range (df < +/- delta)	520 .. 695 nm ⁽¹⁾
Compatibility	
environment	low temperature, high magnetic fields, high vacuum
compatible setups	CFM I, AFM/CFM, attoDRY800
suitable broadband collimator	RT-APO/VIS-NIR/0.13
Size and Dimensions	
diameter	24 mm
length	48.35 mm
weight	43 g



⁽¹⁾ df: chromatic focal shift, $\Delta f = n \cdot \lambda_{\text{ref}} / (2 \cdot NA^2)$; depth of focus, n: refractive index, λ_{ref} : wavelength used to define focal plane with max. Δf

Simulation Data on Chromatic Performance

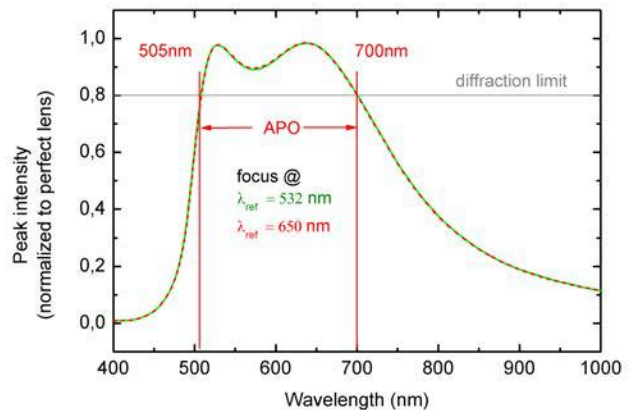
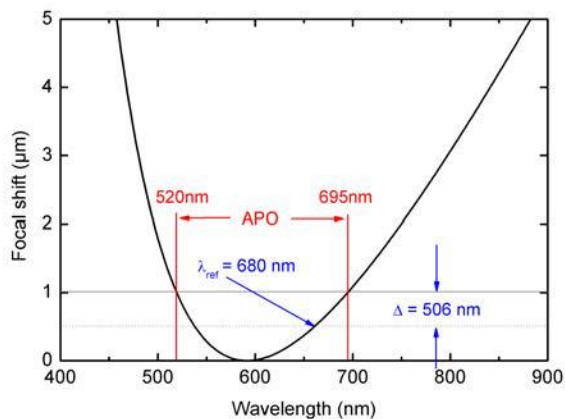

Technical Drawings

